

PART OF THE NE 1/4 OF THE SE 1/4
SECTION 13, TOWN 1 NORTH, RANGE 16 EAST
VILLAGE OF FONTANA—ON—GENEVA ALKE
WALWORTH COUNTY, WISCONSIN

100 50 0 50 100 150 200

MAP SCALE IN FEET ORIGINAL 1" = 60'

SOUTH SHORE DRIVE S 89°23'23" E

LEGEND

○ = FOUND IRON PIPE STAKE
● = FOUND IRON REBAR STAKE
● = SET IRON REBAR STAKE
■ = SET LATH ON LINE
(XXX) = RECORDED AS

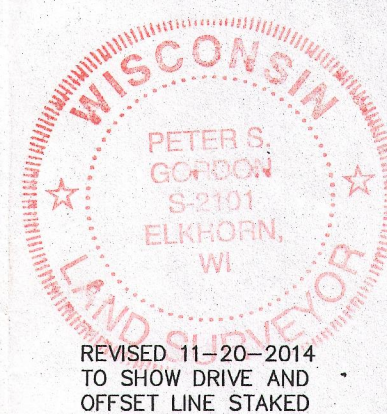

NOTE: COPIES OF THIS MAP TO WHICH THE FOLLOWING CERTIFICATE
WILL APPLY SHOW THE SURVEYOR'S ORIGINAL SEAL AND SIGNATURE
IN RED INK. COPIES BY ANY OTHER MEANS MAY HAVE ALTERATIONS
WHICH DO NOT REPRESENT THE SURVEYOR'S WORK PRODUCT.

I HEREBY CERTIFY THAT THE ABOVE DESCRIBED PROPERTY HAS BEEN SURVEYED UNDER MY DIRECTION AND THAT THE ABOVE MAP IS A TRUE REPRESENTATION THEREOF AND SHOWS THE SIZE AND LOCATION OF THE PROPERTY AND ITS EXTERIOR BOUNDARIES. THIS SURVEY IS MADE FOR THE USE OF THE PRESENT OWNERS OF THE PROPERTY, AND ALSO THOSE WHO PURCHASE, MORTGAGE, OR GUARANTEE THE TITLE THERETO WITHIN ONE YEAR FROM THE DATE HEREOF.

DATED: DECEMBER 4, 2013

PETER S. GORDON R.L.S. 2101

WORK ORDERED BY:
MARIA KLESMITH
1081 S. LAKESHORE DRIVE
FONTANA, WI. 53125

REVISIONS

PROJECT NO.	8885
DATE:	11-22-2013
SHEET NO.	1 OF 1

FARRIS, HANSEN & ASSOCIATES, INC.
ENGINEERING - ARCHITECTURE - SURVEYING
7 RIDGWAY COURT P.O. BOX 437
ELKHORN, WISCONSIN 53121
OFFICE: (262) 723-2098 FAX: (262) 723-5886



11/20/2014 X:\Projects\8885\DCAD\SURVEY

NOV 20 2014

8TFV 00116 005-3096